

Isolator - 20mm Water Service Ball Valve

ISOLATOR - 20MM WATER SERVICE BALL VALVE

Proven WATER SERVICE BALL VALVE....

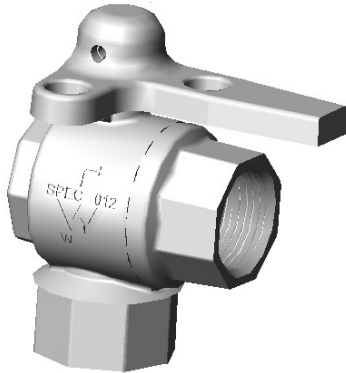

... built TOUGH

**Quality guaranteed
Water Marked
product**

The *Isolator* Range provides:

- * Common base connection configuration, minimising required stock holdings
- * Long life performance, through its high quality components
- * Lightweight construction for ease of handling

Note: product material configuration may vary over size range.

Features

- * Forged DR Gunmetal Body
- * Bottom loading, dual o-ring sealed stem
- * Coated ball, and resilient seats
- * Right Angle (F-F) and Straight Through (M-F) versions
- * Lockable in either Open or Closed position
- * Other sizes (up to 50mm) available, specifications may vary
- * Water Marked to Spec 12

The *Isolator* Ball Valves are a proven industry leading design, and Watermarked to Spec 12.

We can also supply a range of fittings (compression, capillary, etc) to suit most connection needs.

The *Isolator* ball valve range comes in sizes from 20mm to 50mm, in both right angle and straight configurations.