

20S - 20mm Standpipe Backflow Device

Features

- * Compact low maintenance design
- * High flowrate capacity
- * Testable to AS 2845
- * Standards marked backflow device

The 20S is constructed from aluminium, and contains independent modular captured spring check assemblies.

Nominal Size: 20mm

Standards: Backflow Prevention, Double Check Valve to AS 2845.1.

Maximum Working Pressure: 1,600 Kpa.

Maximum Water Temperature: 60° C.

Material: Aluminium.

Compact STANDPIPE BACKFLOW device



The Reliance 20S – Standpipe Backflow Device has been developed specifically for use on small bore standpipes.

The 20S is lightweight, yet robust standards marked backflow device. It is supplied with plugged test ports.

A test port kit is available as an accessory, to allow full compliance testing to AS 2845 requirements.

20S - 20MM STANDPIPE BACKFLOW DEVICE

20S – 20mm Standpipe Backflow Device

20S - 20MM STANDPIPE BACKFLOW DEVICE

Dimensions

Height 200mm

Diameter 65mm

Weight 1.8kg

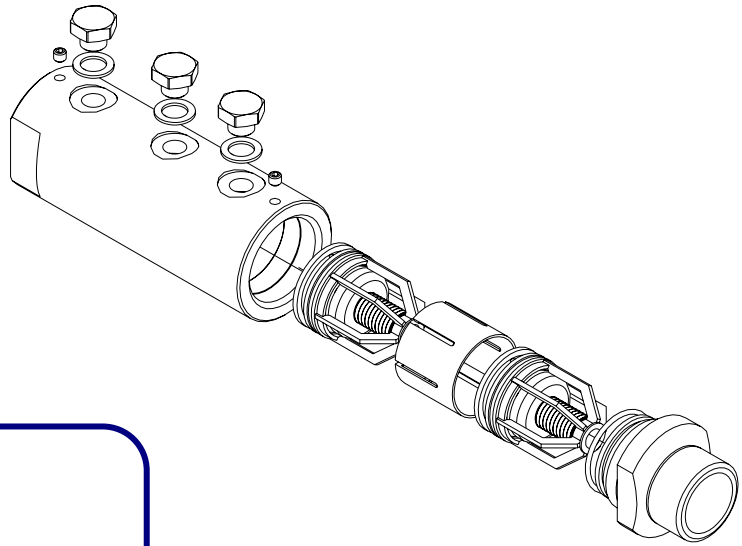

Connections

Inlet Connection 32mm F BSP

Outlet Connection 32mm M BSP

Operation

The **20S** can be fitted to any small bore standpipe. The device is supplied with a factory test certificate.

Due to the high occurrence of contaminants in water flow through standpipes, it is recommended that regular tests of the **20S** be carried out to ensure its continued proper operation, and protection of the potable water supply system from backflow.

At a minimum most major utilities require a certified test to be carried at a maximum 12 month interval.