

32S- 32mm Standpipe Backflow Device

Features

- * Compact low maintenance design
- * High flowrate capacity
- * Ball bearing swivel connection to standpipe
- * Testable to AS 2845
- * Standards marked backflow device

The 32S is constructed from cast aluminium, and contains independent modular captured spring check assemblies.

Nominal Size 32mm

Standards Backflow Prevention, Double Check Valve to AS 2845.1

Maximum Working Pressure 1,600 Kpa

Maximum Water Temperature 40° C

Material Cast Aluminium

Compact STANDPIPE

BACKFLOW device



The 32S – Standpipe Backflow Device has been developed specifically for use on standpipes.

The 32S is lightweight, yet robust standards marked backflow device. It is supplied with plugged test ports.

A test port kit is available as an accessory, to allow full compliance testing to AS 2845 requirements.

32S- 32MM STANDPIPE BACKFLOW DEVICE

32S- 32mm Standpipe Backflow Device

32S- 32MM STANDPIPE BACKFLOW DEVICE

Dimensions

Height 200mm
Depth 200mm
Width 90mm
Weight 2.8kg

Connections

Inlet Connection 32mm F BSP
Outlet Connection 32mm M BSP

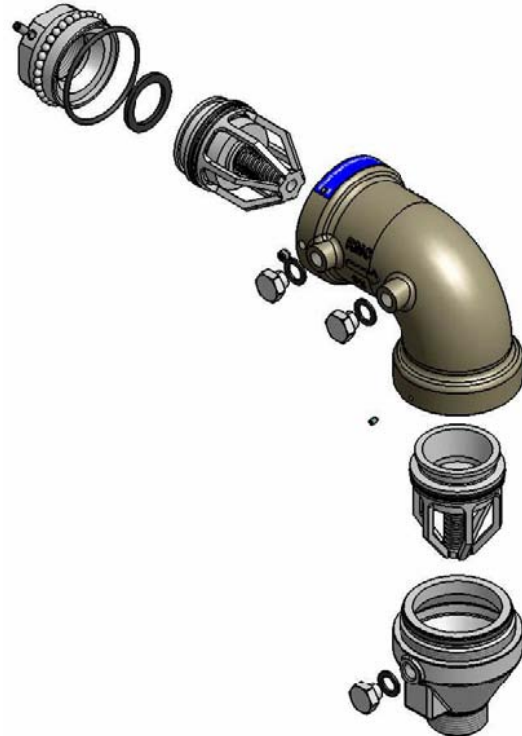

Operation

The **32S** can be fitted to any 32mm outlet standpipe. The device is supplied with a factory test certificate. Due to the high occurrence of contaminants in water flow through standpipes, it is recommended that regular tests of the **32S** be carried out to ensure its continued proper operation, and protection of the potable water supply system from backflow. At a minimum most major utilities require a certified test to be carried at a maximum 12 month interval.